



# AUTEL SIM CARD INSTALLATION GUIDE

---



# TABLE OF CONTENTS

<b>AC Elite Business</b>	<b>3</b>
<b>AC Ultra</b>	<b>3-4</b>
<b>DC Compact</b>	<b>5</b>
<b>DC Fast</b>	<b>6</b>



***Please make sure all electrical components are powered off before working on the stations.***

## **ACDI Energy Services**

403 North Main Street  
Benton, Arkansas 72015  
E: [energyservices@acd-inc.com](mailto:energyservices@acd-inc.com)  
P: +1 800.990.2234



## AC ELITE BUSINESS

---

To connect via the SIM Card

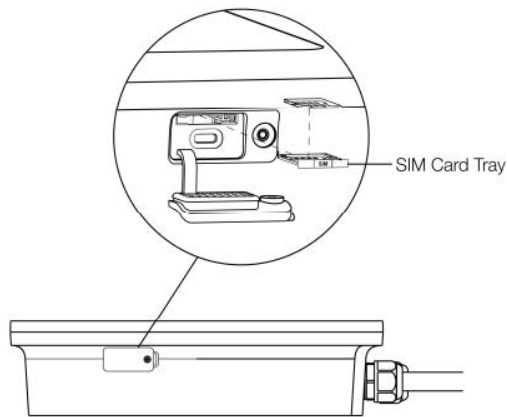

- Remove the SIM Card cover by first unscrewing the M3 x 10 screw using the screwdriver type T10.
- Then, eject the SIM card tray using the screwdriver and place the card into it.
- Make sure that the card is inserted correctly.
- Reinstall the SIM card cover by following the procedures above in reverse order.

## AC ULTRA

---

1. Loosen the upper two M5 x 10 security screws to remove the upper front cover. Set them aside.

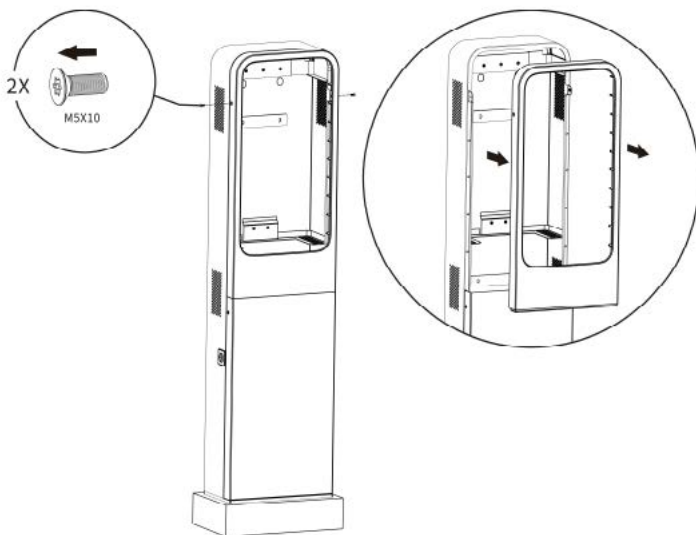

## AC ULTRA CONT'D.

2. Loosen the two M3 x 8 screws at the bottom of the charging stations and set the screws aside.
3. Remove the faceplate and set it aside.

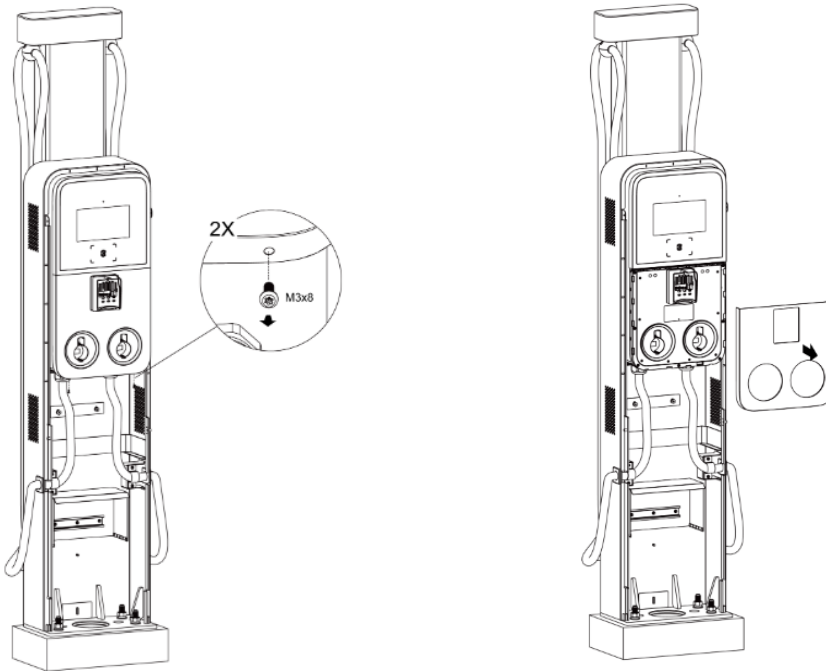

4. Unscrew the eight M3 x 8 screws at the edges of the charging station and set the screws aside.
5. Eject the SIM card tray (B) using the eject button (A) on the right. Place the SIM card into the card tray and ensure it is inserted correctly. Push the card tray back in place.

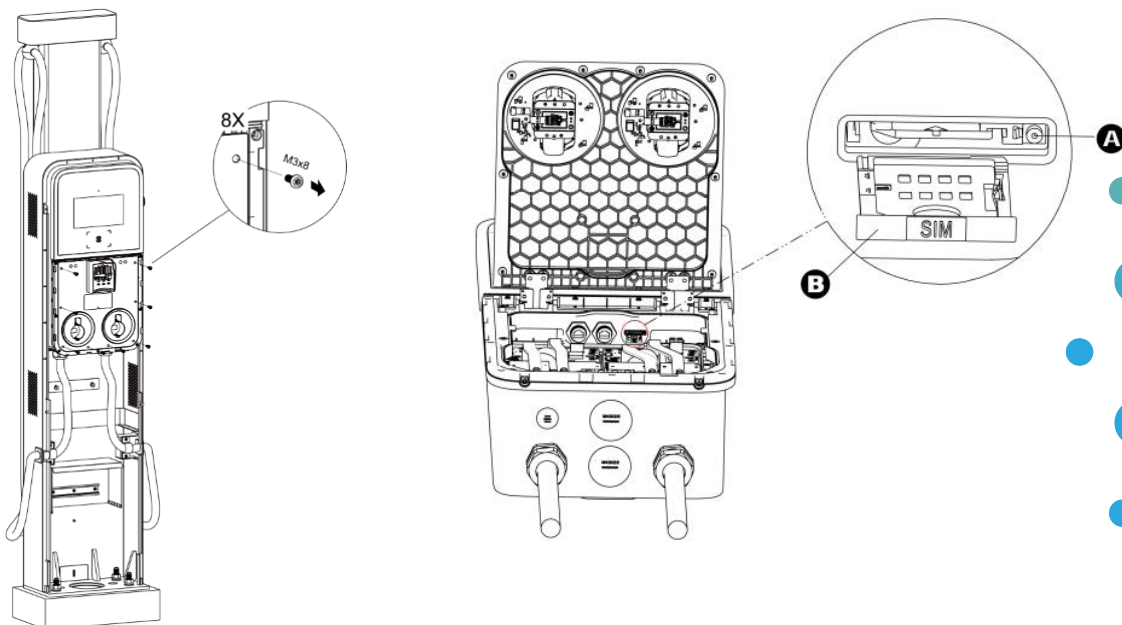

## DC COMPACT

---

1. Remove the six M5 screws on the right side of the MaxiCharger using the T25 Torx screwdriver and remove the side cover (A - left). Set them aside.
2. Loosen the two M8 hex screws (A - right) using the hex key and open the cabinet door.

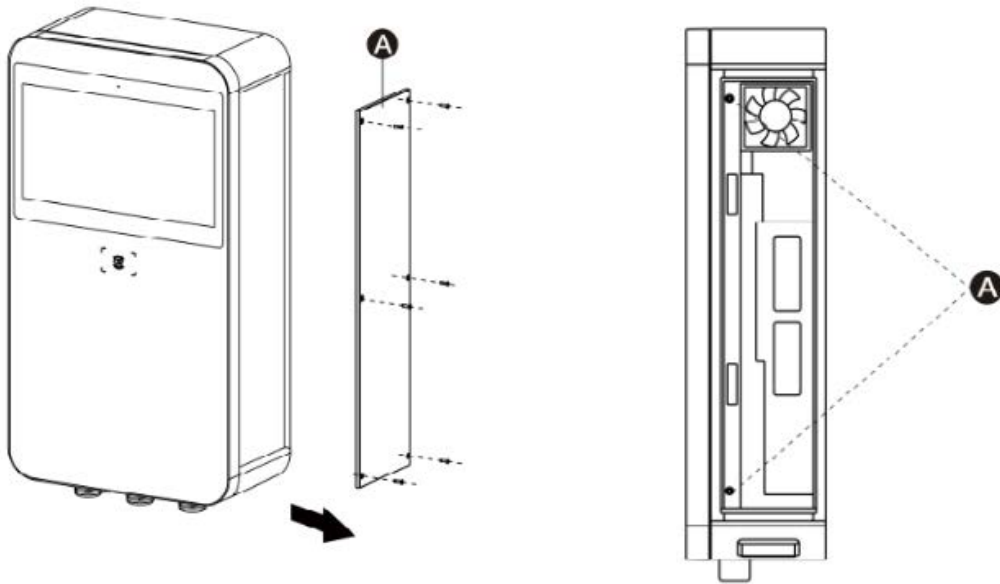

3. Press the button (A - bottom) and slide the card tray to the right to remove it. Place the SIM card into the card tray. Ensure the card is inserted correctly. Reinstall the card tray

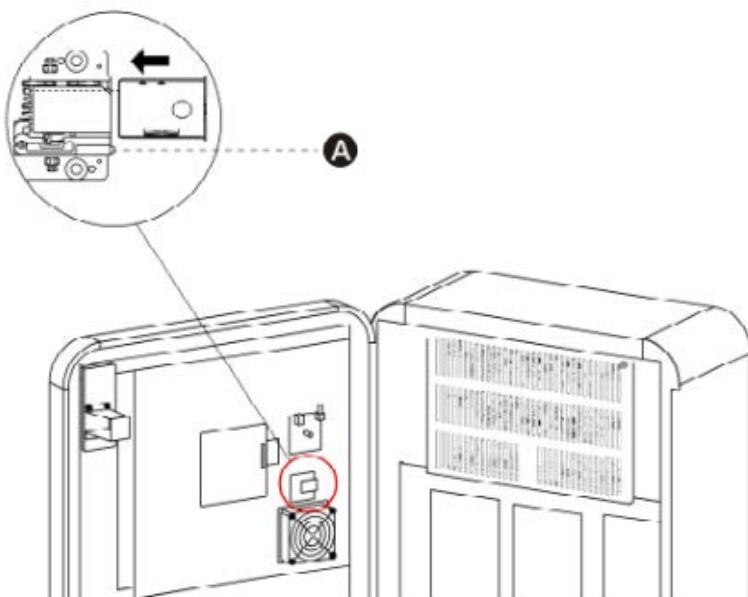

# DC FAST

---

1. Open the cabinet using the Handle Lock (Key required)
2. Press the button (A) to release the SIM card tray. Insert the SIM card into the tray. Ensure the card is placed correctly. Push the card tray into the slot.  
(may have to remove an extra panel if you cannot access the tray)

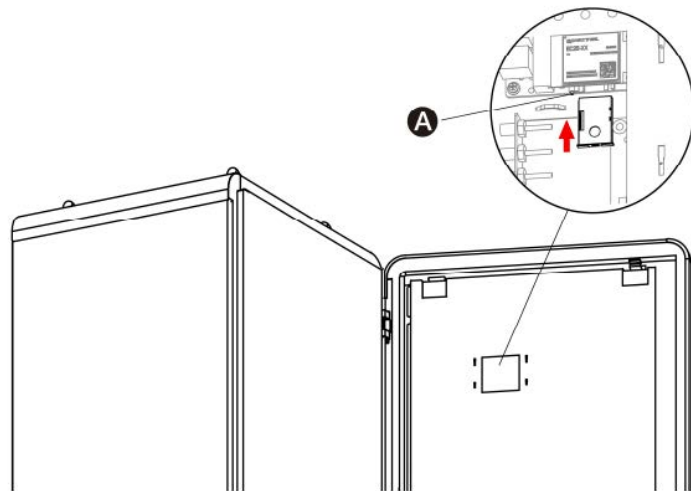

## ACDI Energy Services

403 North Main Street  
Benton, Arkansas 72015  
E: [energyservices@acd-inc.com](mailto:energyservices@acd-inc.com)  
P: +1 800.990.2234

